

# Martin Yale 62001 Parts List 24999 and Below



Provided By

**MyBinding**.com®  
*When Image Matters.*

## 62001 Parts List

<u>Item</u>	<u>Part Number</u>	<u>Qty.</u>	<u>Description</u>
1	W-A62000001	1	Housing Assembly
2	W-O62000007	1	Upright Support R. H.
3	W-O62000006	1	Upright Support L. H.
4	W-O62000011	1	Horizontal Frame
5	W-O62000012	1	Vertical Frame
6	M-O62000048	3	Nylon Roller
7	M-O62000072	1	Small Shaft
8	M-S62000046	2	Shoulder Bolt
9	W-A62000705	1	Double Pulley
10	W-A62000036	2	Eccentric Pulley Assembly
11	W-A62000709	1	Shaft Housing Assembly
12	M-S63751547	1	Control Knob
13	M-S62000285	1	Spring
14	M-S62000057	2	5/16 Flat Washer
15	W-O62000063	1	Small Shaft Spring
16	W-O62000310	1	Main Shaft
17	M-S008022	1	1/2" X 3/4" Wave Washer
18	W-O022021	1	Cutter shaft pulley
19	M-S010005	2	E Ring Retainer
20	W-O62000086	1	Knife Back Up Disk
21	M-O62000077	1	Shaft Spacer
22	W-O62000064	1	Lower Knife Guard
23	M-O62000082	1	Ejector Wheel Rubber
24	M-O62000081	1	Ejector Wheel
25	M-S6120042	3	1/4 X 1 Shoulder Bolt
26	M-O62000196	1	Transport Wheel
27	W-O62000206	1	Front Deck
28	M-S63251497	1	Main Switch
29	W-A62000156	1	Front Panel
30	W-O62000106	1	Pressure Plate
31	W-O62000101	1	Ski
32	M-O06800001	14	6-32 X 3/8 Self Tap Screw
33	W-O62000131	1	Upper Knife Guard
34	M-S62000091	1	6-32 X 1 S. H. C. S.
35	M-S007003	2	6-32 Hex Nuts
36	M-O62000103	2	Ski Pivot
37	M-S62000104	4	Pivot Retainer
38	M-S62000117	2	Ski Arm Spring
39	M-S63751118	2	1/4 - 20 X 2" Large S. H. C. S.
40	M-S001053	1	10-32 X 1/2 Pan Head Screw

41	M-S62000136	1	Hold Back Wheel
42	W-A62000137	1	Hold Back Assembly
43	M-S63751510	1	¼-20 X 2 ¼ S. H. C. S.
44	M-S62000043	2	External Lock Washer
45	W-A62000096	1	Rear Deck Assembly
46	W-A62000141	1	Feed Stop Plate Assembly
47	M-S62000144	1	Nylon Hex Cap Nut
48	M-S62000171	1	Interlock Switch
49	M-S007021	2	Jam Nut
50	M-S61000058	3	10-32 Hex Nut
51	M-S003048	1	10-32 X 1 ½ S. H. C. S.
52	M-S63251449	4	Kep Nut ¼- 20
53	W-O62000102	2	Ski Arm
54	M-S63751583	2	10-32 X 1 S. H. C. S.
55	W-A62000121	1	Hinged Cover
56	W-A62000186	1	Rear Panel
57	M-S022023	1	12 Tooth Pulley
58	M-S025010	1	210 X L Timing Belt
59	M-S63000029	1	Motor
60	M-S62000308	1	Motor Bracket
61	M-S62000151	2	Feed Belt
62	M-S62000073	2	3/8 – 16 Left Hand Hex Nut
63	M-S62000166	1	1 Amp Circuit Breaker
64	M-S62000320	1	Lock Washer
65	W-O62000071	1	Small Knife
66	W-O62001187	1	Large Knife
67	W-O62000309	1	Belt Guard
68	W-O62000126	1	Scrap Chute
69	W-A62000021	1	Single Pulley
70	WRA032045	1	Thumb Screw Knob

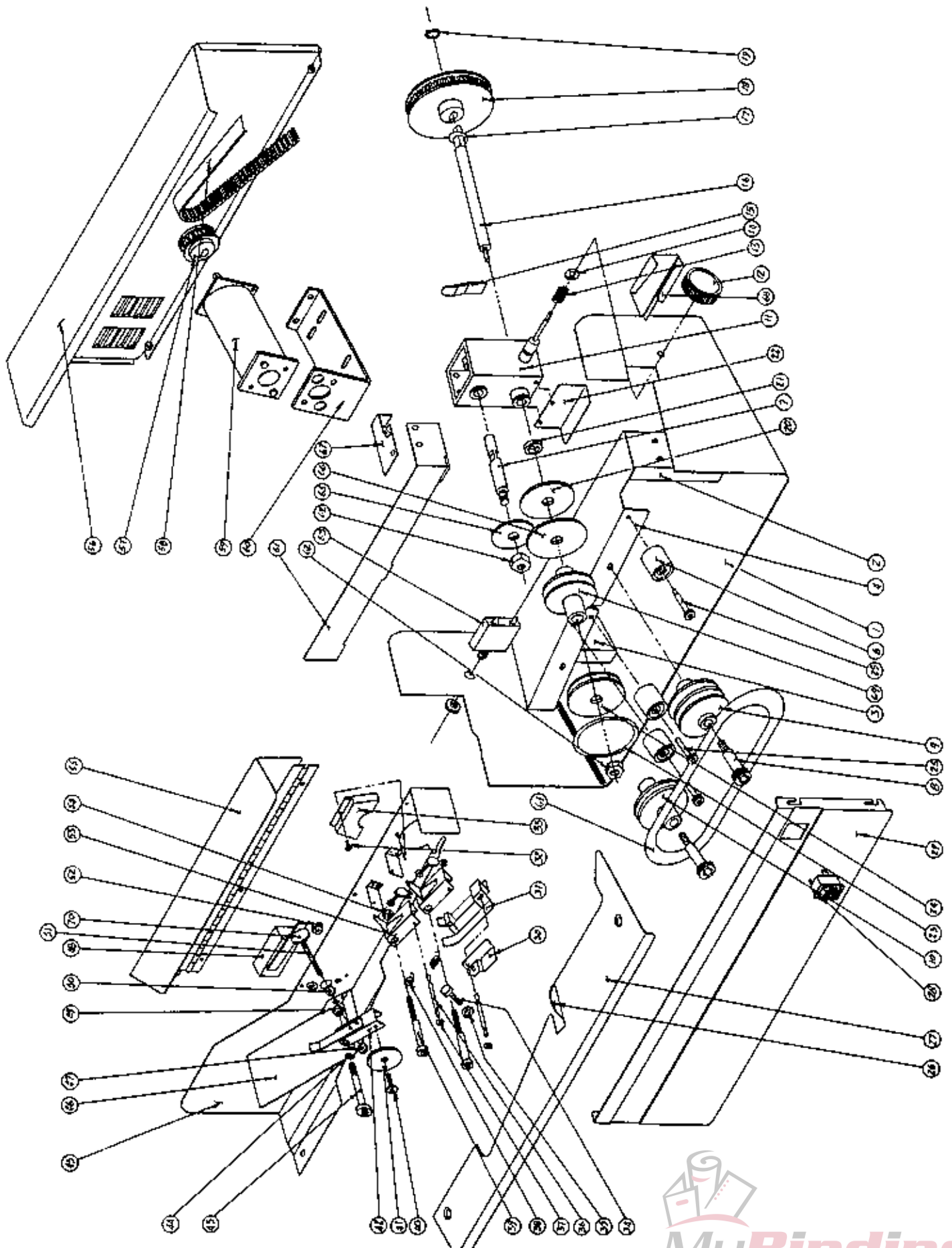

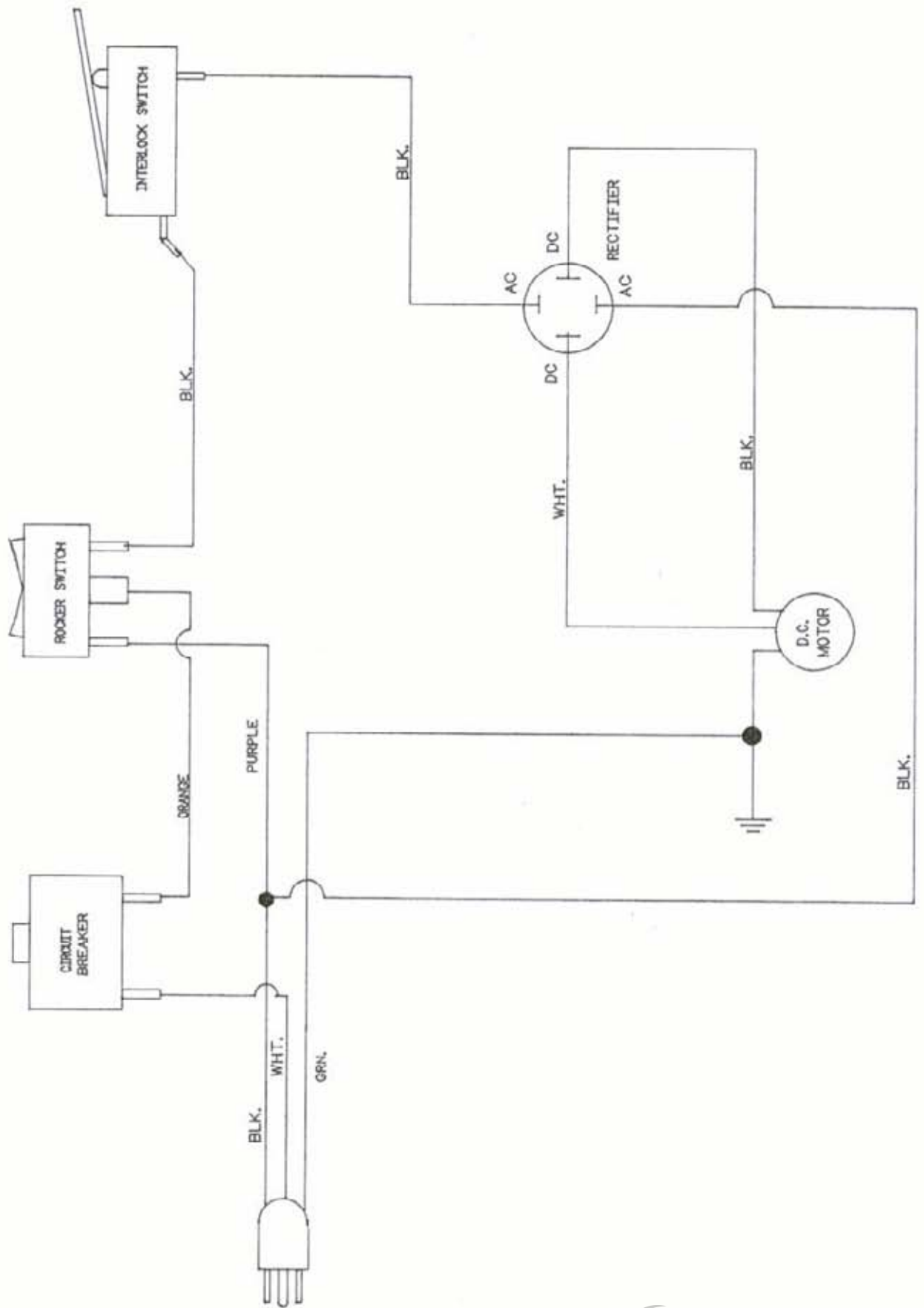

# We Have it All...



## **MyBinding.com** *When Image Matters.*

**Guaranteed Lowest Prices** on an  
Endless Selection of Binding Systems, Laminators,  
Paper Shredders, Supplies and Accessories.

**We have you covered** with Expert Advice  
and Support. Our popular blog keeps you up to  
date on the latest tips and techniques to make  
your most important binding and laminating  
tasks a success.

**Call Us Today**

**1-800-944-4573**

### **Our Trusted Partners**

GBC / Ibico  
Fellowes  
Powis Fastback  
Unibind  
Akiles  
Renz  
Tamerica  
Rhin-O-Tuff  
DFG

Pro-Bind  
Martin Yale  
MBM  
Formax  
Intimus  
Dahle  
HSM  
Standard  
Xyron

Challenge  
Lasko-Wizer  
GBC Shredmaster  
Avery  
Wilson Jones  
Cardinal  
Samsill  
Universal

- BINDING MACHINES
- BINDING SUPPLIES
- LAMINATORS
- I.D. ACCESSORIES
- BOARDS & EASELS
- PAPER SHREDDERS
- XYRON LAMINATORS
- COIL BINDING MACHINES
- UNIBIND BINDING MACHINES
- FASTBACK BINDING EQUIPMENT
- PAPER FOLDING MACHINES
- LAMINATING POUCHES
- ROTARY TRIMMERS
- CLEAR COVERS
- TWIN LOOP WIRE
- REGENCY COVERS
- PLASTIC BINDING COVERS
- VELOBIND BINDING MACHINES
- PAPER HANDLING EQUIPMENT
- THERMAL BINDING MACHINES
- PROCLICK BINDING SYSTEMS
- COMB BINDING MACHINES
- COMB BINDING SUPPLIES
- WIRE BINDING MACHINES
- POUCH LAMINATORS
- LAMINATING ROLLS
- 3-RING BINDERS
- ROLL LAMINATORS
- VELOBIND SPINES
- PAPER CUTTERS
- PAPER JOGGERS
- LETTER OPENERS
- THERMAL COVERS
- UNIBIND SUPPLIES
- PROCLICK SPINES
- ZIPBIND SPINES
- LINEN COVERS
- SPIRAL COIL
- INDEX TABS

